

Technical data sheet

Product features



Fry-top griddle plate 56x51 gas combined on open cabinet

Model

SAP Code

00001046



- Top type: Combined
- Griddle dimensions [mm x mm]: 560 x 510
- Griddle thickness [mm]: 14.00
- Worktop material: Stainless steel
- Container for liquid fat: Yes
- Maximum device temperature [°C]: 300
- Removable rim: Yes
- Ignition: Piezo+večný plamen

SAP Code	00001046	Power gas [kW]	10.500
Net Width [mm]	600	Type of gas	Natural gas, propane butane
Net Depth [mm]	705	Griddle dimensions [mm x mm]	560 x 510
Net Height [mm]	900	Top type	Combined
Net Weight [kg]	83.00	Worktop type	Molded - comfortable cleaning maintenance

Technical drawing



Model

SAP Code

00001046

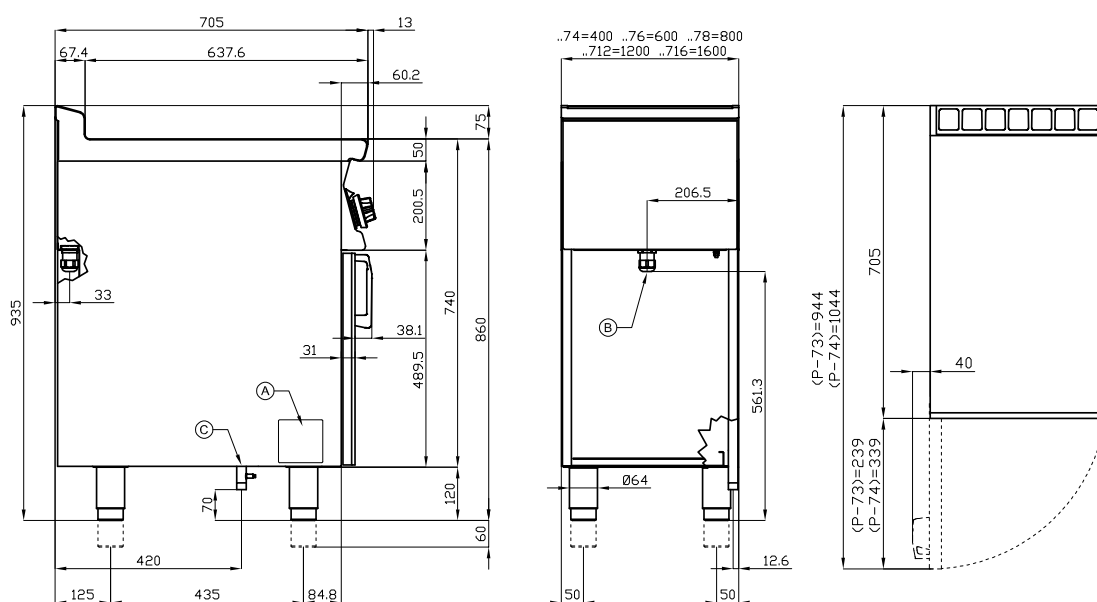

A	Data plate		C	Gas connection	ISO 7-1 1/2" M
---	------------	--	---	----------------	----------------

Technical data sheet

Product benefits



Fry-top griddle plate 56x51 gas combined on open cabinet

Model	SAP Code	00001046
-------	----------	----------

1

Safety element – thermocouple

safe service for staff
there is no unnecessary gas leakage
long life

- savings on service interventions
- easier and faster operation

2

All-stainless design

long life
resistance of AISI 304 stainless steel material
the material does not cut

- savings on service interventions
- easy cleaning and maintenance of equipment

3

Degree of protection of the control elements IPX5

maintenance-free system
resistance to splash water
long life

- savings on service interventions
- easy cleaning and maintenance of equipment

4

Outlet for waste liquids

ensures that oil drips into the socket

- easy maintenance
- easy cleaning

5

High detachable hem

better hygienic conditions
preventing grease from splashing onto ancillary equipment

- easy maintenance
- easy cleaning

6

Combined steel plate

good heat transfer and the surface does not get scratched
enables preparation on smooth or grooved plates

- time-saving in food preparation
- easy preparation of different types of dishes

7

Outlet for waste liquids

ensures that oil drips into the socket

- easy maintenance
- easy cleaning

8

Combined grilling area

straight and grooved grid

- the possibility of preparing several types of gastronomic treatments at the same time
- separate control of each area

Technical data sheet

Technical parameters



Fry-top griddle plate 56x51 gas combined on open cabinet

Model

SAP Code

00001046

1. SAP Code:

00001046

2. Article group:

Frying plates

3. Net Width [mm]:

600

4. Net Depth [mm]:

705

5. Net Height [mm]:

900

6. Net Weight [kg]:

83.00

7. Gross Width [mm]:

630

8. Gross depth [mm]:

770

9. Gross Height [mm]:

1110

10. Gross Weight [kg]:

83.00

11. Device type:

Gas unit

12. Construction type of device:

Stationary

13. Power gas [kW]:

10.500

14. Ignition:

Piezo+večný plamen

15. Type of gas:

Natural gas, propane butane

16. Protection of controls:

IPX5

17. Device color:

Stainless steel

18. Material:

Stainless steel

19. Indicators:

operation and warm-up

20. Worktop type:

Molded - comfortable cleaning maintenance

21. Worktop material:

Stainless steel

22. Worktop Thickness [mm]:

2.00

23. Standard equipment for device:

comes with a stainless steel scraper for cleaning pastries

24. Maximum device temperature [°C]:

300

25. Minimum device temperature [°C]:

50

26. Power control type:

knob control

27. Service accessibility:

Trough the frontal panel

28. Safety element:

safety thermostat

Technical data sheet

Technical parameters



Fry-top griddle plate 56x51 gas combined on open cabinet

Model	SAP Code	
		00001046

29. Safety thermostat:

Yes

30. Adjustable feet:

Yes

31. Additional information:

door not included - can be purchased

32. Griddle dimensions [mm x mm]:

560 x 510

33. Griddle thickness [mm]:

14.00

34. Container for liquid fat:

Yes

35. Removable rim:

Yes

36. Uniform heating:

Yes

37. Top type:

Combinated