

Technical data sheet



Product features

Fry-top griddle plate 65x48 electric combined counter top 400 V

Model	SAP Code	00000992
--------------	-----------------	----------



- Top type: Combined
- Griddle dimensions [mm x mm]: 650 x 480
- Griddle thickness [mm]: 10.00
- Container for liquid fat: Yes
- Independent heating zones: Separate control for each heating zone
- Maximum device temperature [°C]: 300
- Surface finish: sandblasted surface without coating
- Removable rim: No

SAP Code	00000992	Power electric [kW]	6.000
Net Width [mm]	658	Loading	400 V / 3N - 50 Hz
Net Depth [mm]	541	Griddle dimensions [mm x mm]	650 x 480
Net Height [mm]	285	Top type	Combined
Net Weight [kg]	43.00		

Technical data sheet



Technical drawing

Fry-top griddle plate 65x48 electric combined counter top 400 V

Model	SAP Code	00000992
-------	----------	----------

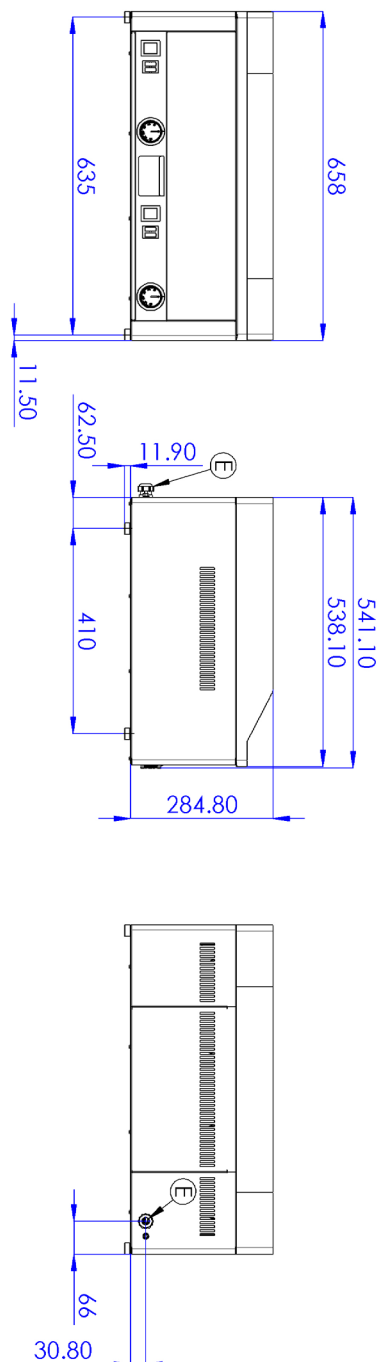

Technical data sheet



Product benefits

Fry-top griddle plate 65x48 electric combined counter top 400 V

Model

SAP Code

00000992

1

All-stainless design

- long life
- resistance of AISI 304 stainless steel material
- the material does not cut
 - savings on service interventions
 - easy cleaning and maintenance of equipment

2

Degree of protection of the control elements IPX4

- maintenance-free system
- resistance to splash water
- long life
 - savings on service interventions
 - easy cleaning and maintenance of equipment

3

Outlet for waste liquids

- ensures that oil drips into the socket
 - easy maintenance
 - easy cleaning

4

High non-removable hem

- better hygienic conditions
- preventing grease from splashing onto ancillary equipment
 - easy maintenance
 - easy cleaning

5

Combined plate made of sandblasted steel

- good heat transfer
- enables preparation on smooth or grooved plates
 - time-saving in food preparation
 - easy preparation of different types of dishes

6

Cooking unit for use on a table or on a base

- variable use
- the possibility of placement in smaller spaces
 - easy handling
 - cost savings on substructure

Technical data sheet



Technical parameters

Fry-top griddle plate 65x48 electric combined counter top 400 V

Model	SAP Code	00000992
--------------	-----------------	----------

1. SAP Code:

00000992

15. Material:

AISI 430

2. Net Width [mm]:

658

16. Indicators:

operation and warm-up

3. Net Depth [mm]:

541

17. Surface finish:

sandblasted surface without coating

4. Net Height [mm]:

285

18. Maximum device temperature [°C]:

300

5. Net Weight [kg]:

43.00

19. Minimum device temperature [°C]:

50

6. Gross Width [mm]:

640

20. Adjustable feet:

Yes

7. Gross depth [mm]:

725

21. Griddle dimensions [mm x mm]:

650 x 480

8. Gross Height [mm]:

410

22. Griddle thickness [mm]:

10.00

9. Gross Weight [kg]:

45.00

23. Container for liquid fat:

Yes

10. Device type:

Electric unit

24. Independent heating zones:

Separate control for each heating zone

11. Construction type of device:

Table top

25. Removable rim:

No

12. Power electric [kW]:

6.000

26. Uniform heating:

Yes

13. Loading:

400 V / 3N - 50 Hz

27. Top type:

Combinated

14. Protection of controls:

IPX4