

Technical data sheet

Product features



Electric fryer 19,8 kW

| | | |
|--------------|-----------------|----------|
| Model | SAP Code | 00008460 |
|--------------|-----------------|----------|



- Basin volume [l]: 13+13
- Drain type: Trough the cabinet
- Maximum device temperature [°C]: 190
- Minimum device temperature [°C]: 50
- Material: AISI 304 top plate and cladding
- Heating location: Inside the tank
- Number of baskets: 2
- Basket dimensions [mm x mm x mm]: 215 x 300 x 120

| | | | |
|----------------------------|----------|---|--------------------|
| SAP Code | 00008460 | Loading | 400 V / 3N - 50 Hz |
| Net Width [mm] | 800 | Basin volume [l] | 13+13 |
| Net Depth [mm] | 730 | Number of basins | 2 |
| Net Height [mm] | 900 | Number of baskets | 2 |
| Net Weight [kg] | 81.00 | Basket dimensions [mm x mm x mm] | 215 x 300 x 120 |
| Power electric [kW] | 19.800 | Ratio power/volume [kW/l] | 0.96 |

Technical data sheet

Technical drawing



Electric fryer 19,8 kW

Model

SAP Code

00008460

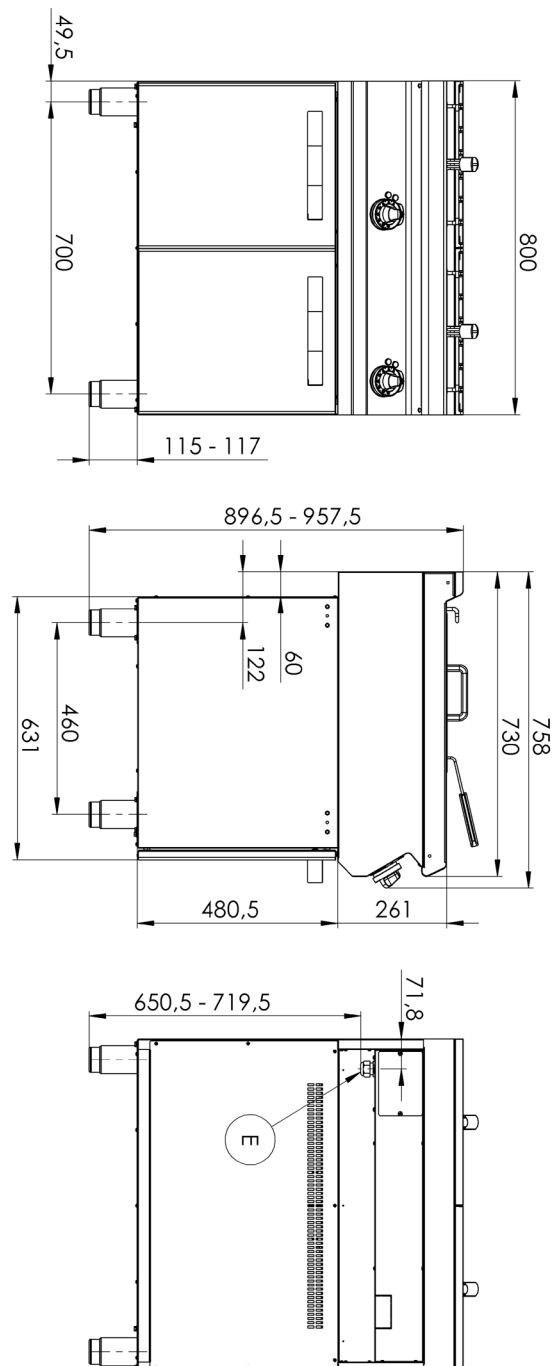

Technical data sheet

Technical parameters



Electric fryer 19,8 kW

Model

SAP Code

00008460

1. SAP Code:

00008460

2. Net Width [mm]:

800

3. Net Depth [mm]:

730

4. Net Height [mm]:

900

5. Net Weight [kg]:

81.00

6. Gross Width [mm]:

840

7. Gross depth [mm]:

800

8. Gross Height [mm]:

1065

9. Gross Weight [kg]:

94.00

10. Device type:

Electric unit

11. Construction type of device:

With substructure

12. Power electric [kW]:

19.800

13. Loading:

400 V / 3N - 50 Hz

14. Protection of controls:

IPX4

15. Device color:

Stainless steel

16. Material:

AISI 304 top plate and cladding

17. Indicators:

operation and warm-up

18. Worktop type:

Molded - comfortable cleaning maintenance

19. Worktop material:

AISI 304

20. Worktop Thickness [mm]:

1.50

21. Device heating type:

Direct

22. Standard equipment for device:

lid and basket

23. Basin volume [l]:

13+13

24. Basin dimensions [mm x mm x mm]:

265 x 346 x 200

25. Maximum device temperature [°C]:

190

26. Minimum device temperature [°C]:

50

27. Safety thermostat:

Yes

28. Heating element material:

AISI 304

Technical data sheet

Technical parameters



Electric fryer 19,8 kW

Model

SAP Code

00008460

29. Number of baskets:

2

33. Ratio power/volume [kW/l]:

0.96

30. Number of basins:

2

34. Drain type:

Trough the cabinet

31. Basket dimensions [mm x mm x mm]:

215 x 300 x 120

35. Heating location:

Inside the tank

32. Basin material:

AISI 304 - High quality stainless steel