

# Technical data sheet

## Product features



### Cooking range s induction electric on open cabinet

|              |                 |          |
|--------------|-----------------|----------|
| <b>Model</b> | <b>SAP Code</b> | 00014764 |
|--------------|-----------------|----------|



- Device type: Electric unit
- Power consumption of the zone 1 [kW]: 3,5
- Power consumption of the zone 2 [kW]: 3,5
- Power consumption of the zone 3 [kW]: 3,5
- Power consumption of the zone 4 [kW]: 3,5
- Protection of controls: IP24
- Material: AISI 304 top plate and cladding

|                            |          |   |                    |
|----------------------------|----------|---|--------------------|
| <b>SAP Code</b>            | 00014764 | <b>Loading</b>                              | 400 V / 3N - 50 Hz |
| <b>Net Width [mm]</b>      | 800      | <b>Number of zones</b>                      | 4                  |
| <b>Net Depth [mm]</b>      | 730      | <b>Power consumption of the zone 1 [kW]</b> | 3,5                |
| <b>Net Height [mm]</b>     | 900      | <b>Power consumption of the zone 2 [kW]</b> | 3,5                |
| <b>Net Weight [kg]</b>     | 89.00    | <b>Power consumption of the zone 3 [kW]</b> | 3,5                |
| <b>Power electric [kW]</b> | 14.000   | <b>Power consumption of the zone 4 [kW]</b> | 3,5                |

# Technical data sheet

Technical drawing



Cooking range s induction electric on open cabinet

Model

SAP Code

00014764

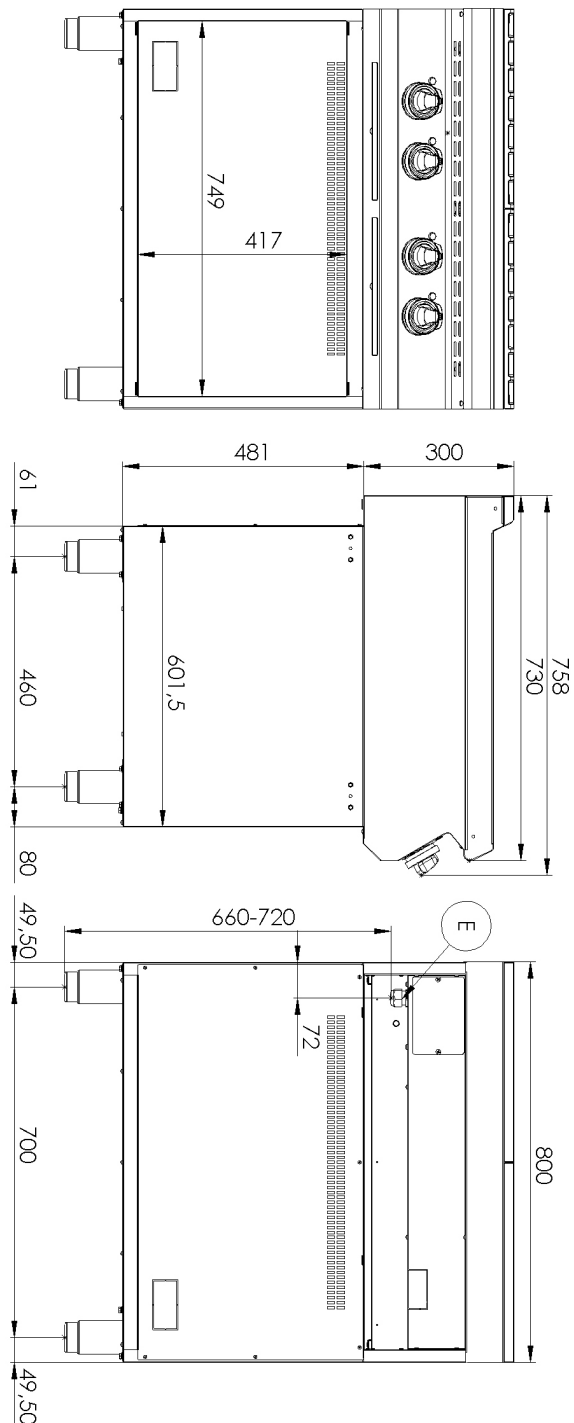
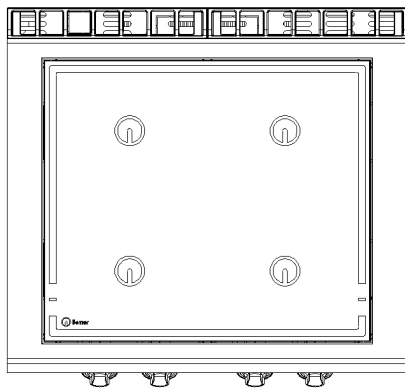

# Technical data sheet

Technical parameters



## Cooking range s induction electric on open cabinet

**Model**

**SAP Code**

00014764

**1. SAP Code:**

00014764

**2. Net Width [mm]:**

800

**3. Net Depth [mm]:**

730

**4. Net Height [mm]:**

900

**5. Net Weight [kg]:**

89.00

**6. Gross Width [mm]:**

860

**7. Gross depth [mm]:**

820

**8. Gross Height [mm]:**

1080

**9. Gross Weight [kg]:**

103.00

**10. Device type:**

Electric unit

**11. Construction type of device:**

With substructure

**12. Power electric [kW]:**

14.000

**13. Loading:**

400 V / 3N - 50 Hz

**14. Protection of controls:**

IP24

**15. Device color:**

Stainless steel

**16. Material:**

AISI 304 top plate and cladding

**17. Indicators:**

operation

**18. Worktop type:**

Molded - comfortable cleaning maintenance

**19. Worktop material:**

AISI 304

**20. Worktop Thickness [mm]:**

1.50

**21. Number of zones:**

4

**22. Power consumption of the zone 1 [kW]:**

3,5

**23. Power consumption of the zone 2 [kW]:**

3,5

**24. Power consumption of the zone 3 [kW]:**

3,5

**25. Power consumption of the zone 4 [kW]:**

3,5

**26. Service accessibility:**

Trough the frontal panel

**27. Adjustable feet:**

Yes

**28. Number of burners/hot plates:**

4

# Technical data sheet

Technical parameters



## Cooking range s induction electric on open cabinet

|              |                 |          |
|--------------|-----------------|----------|
| <b>Model</b> | <b>SAP Code</b> | 00014764 |
|--------------|-----------------|----------|

### 29. Type of electric cooking zones:

Induction