

Technical data sheet

Product features



Pot and pan washer double skin 55x61 - 400 V

Model	SAP Code	00011966
--------------	-----------------	----------



- Display type: LCD multifunction display
- Number of programs: 8
- Number of skin: 2
- Door clear height [mm]: 650
- Rack size [mm]: 560 x 630
- Water consumption of the washing cycle: 3
- Detergent and rinse pump system: ProDose - accurate dosing with a peristaltic pump
- Wash pump type: two-way - DuoFlow
- Self-cleaning cycle: Yes
- Drain filter: Evolution3 - double filtration with electronically controlled partial discharge before the rinsing phase ensures 0% loss of clean water to waste

SAP Code	00011966	Power electric [kW]	10.500
Net Width [mm]	782	Loading	400 V / 3N - 50 Hz
Net Depth [mm]	719	Water consumption of the washing cycle	3
Net Height [mm]	1727	Door clear height [mm]	650
Net Weight [kg]	148.00	Rack size [mm]	560 x 630

Technical data sheet

Technical drawing



Pot and pan washer double skin 55x61 - 400 V

Model

SAP Code

00011966

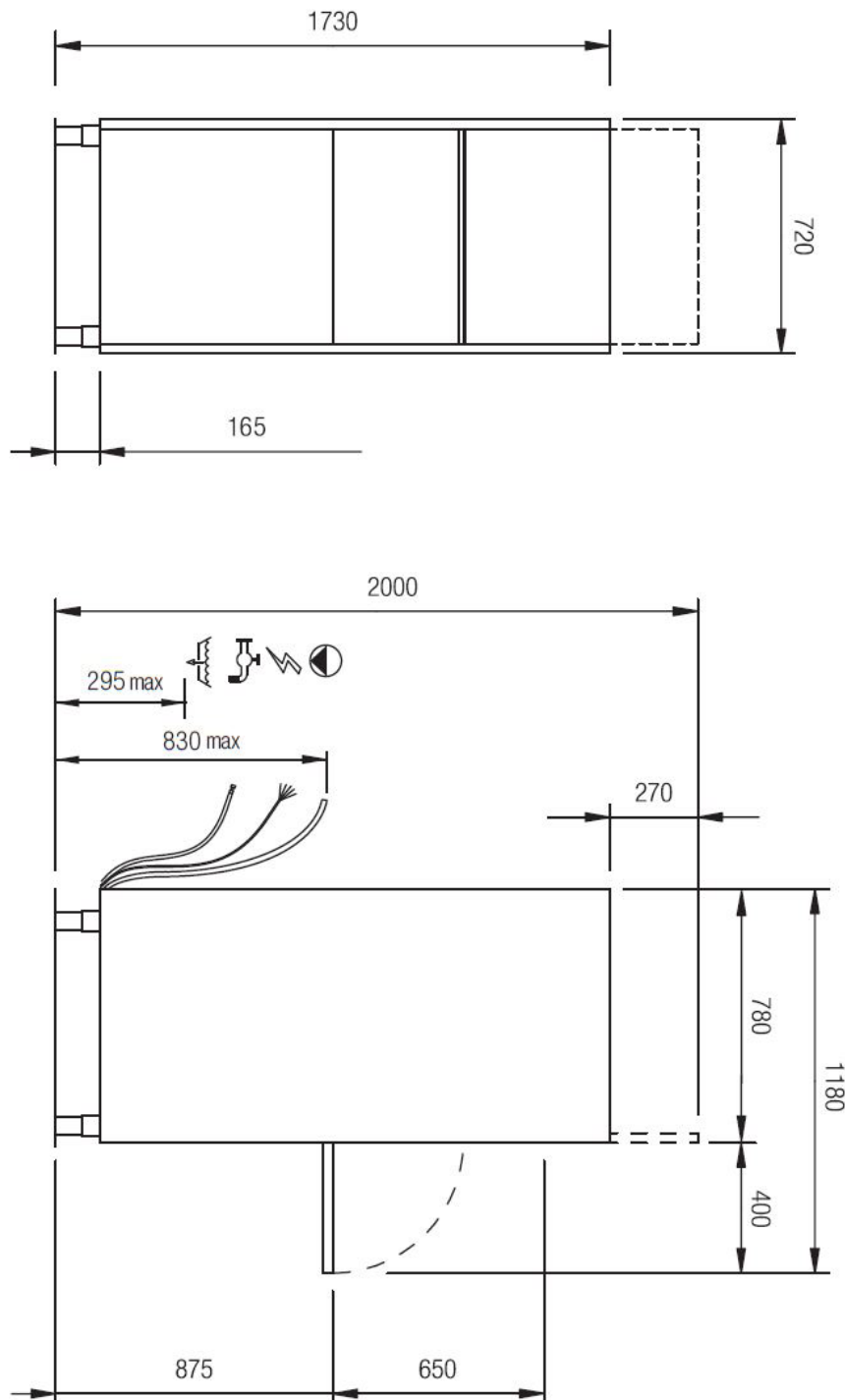

Technical data sheet

Product benefits



Pot and pan washer double skin 55x61 - 400 V

Model	SAP Code	00011966
-------	----------	----------

1 **Stainless steel outer shell construction**
round construction with stainless steel, rounded edges, Deep-drawn bathtub
– easy cleaning, high hygiene standard, long service life

2 **Stainless steel washing arms**
upper and lower arms with stainless steel, separated for washing and rinsing, triple upper arm
– easy and safe handling during cleaning; higher user comfort

3 **LED Display**
smartScreen, a large color graphic display showing the washing progress
– easy control of the dishwasher operation
– continuous information on the status of the wash cycle
– diagnostics in the event of a fault

4 **Double pump**
unique two-way DuoFlow pump
– distributes the water pressure evenly between the upper and lower arms; no noise; allows the use of a weaker pump

5 **Detergent dispensers**
two detergent and rinse aid dispensers
– precise chemical dosing by ProDose - precise dosing system for detergent and rinse aid by peristaltic pump setting of values via control panel

6 **Double filter system**
the chamber filter and the waste filter together with the ArchiMedes system provide a discharge system with increased water purification efficiency
– higher washing efficiency; longer life of the washing bath

7 **Energy saving**
energy saving energy saving system due to lowering the temperature of the boiler
– cost saving

8 **Protection of fragile dishes**
softstart system for gradual start of washing programs to protect fragile dishes
– protects stemmed glasses and other fragile utensils

9 **Double shell construction**
stainless steel construction with insulated double jacket
– quiet operation
– energy saving

10 **Fast heating**
performance management allows the current running of the boiler and basins body
– quick first warm-up of the dishwasher
– smooth operation

11 **Air break tank**
the open system of the boiler rinse, in cooperation with the rinse pump, ensures a constant pressure and temperature of the rinse
– possibility to use in HACCP systems water temperature suitable for sterilization

Technical data sheet

Technical parameters



Pot and pan washer double skin 55x61 - 400 V

Model

SAP Code

00011966

1. SAP Code:

00011966

2. Net Width [mm]:

782

3. Net Depth [mm]:

719

4. Net Height [mm]:

1727

5. Net Weight [kg]:

148.00

6. Gross Width [mm]:

870

7. Gross depth [mm]:

890

8. Gross Height [mm]:

2200

9. Gross Weight [kg]:

157.00

10. Device type:

Electric unit

11. Control type:

Digital

12. Material:

AISI 304

13. Power electric [kW]:

10.500

14. Loading:

400 V / 3N - 50 Hz

15. Number of programs:

8

16. Opening of device:

Tilting down

17. Door clear height [mm]:

650

18. Inlet pressure:

2-4bar

19. Adjustable feet:

Yes

20. Number of skin:

2

21. Self-cleaning cycle:

Yes

22. Number of arms for both rinsing and washing:

2

23. Arm connection:

Click-clack - easy removal with one hand

24. Washing arm type:

Rotating trident

25. Washing arm material:

Composite

26. Atmospheric boiler with rinse pump:

Yes

27. Rinsing arm type:

Rotating trident

28. Rinsing arm material:

Composite

Technical data sheet

Technical parameters



Pot and pan washer double skin 55x61 - 400 V

Model

SAP Code

00011966

29. Deep drawn tank:

Yes

30. Rack support:

Pressed

31. Tank surface strainers:

stainless steel

32. Drain filter:

Evolution3 - double filtration with electronically controlled partial discharge before the rinsing phase ensures 0% loss of clean water to waste

33. Thermostop:

Yes

34. Boiler thermostat adjust:

Yes

35. Detergent and rinse pump system:

ProDose - accurate dosing with a peristaltic pump

36. Energy Saving system:

EnergySaving - Energy saving system due to lowering the boiler temperature

37. Rinse system:

ProRinse - composite arms common for rinsing and washing with geometry for spraying water in thin jets directly against the dishes, the rinsing pump ensures constant pressure

38. Heating system:

HotWash - System of simultaneous operation of the heating element of the bath and the boiler, reducing the time for starting the next cycle

39. Quick heating system:

QuickReady - System for rapid heating of water in the tank

40. Hot water electric valve:

Yes

41. Closing door system:

ProSoft - Reduces noise, dampens the door stop, which could cause damage to dishes

42. Rack size [mm]:

560 x 630

43. Display type:

LCD multifunction display

44. USB port:

Yes, for Firmware actualisation

45. Self-diagnostics:

Yes

46. Wash pump type:

two-way - DuoFlow

47. Detergent dispenser:

Yes

48. Rinse aid dispenser:

Yes

49. Water consumption of the washing cycle:

3

50. Additional information:

The product comes with 1x RM Clean+ 12 kg (00012271) and 1x RM Rinse+ 10 kg (00012273) for free

Technical data sheet

Technical parameters



Pot and pan washer double skin 55x61 - 400 V

Model

SAP Code

00011966

51. Program ProFessional 2:

Yes

55. Program ProFessional 10:

Yes

52. Program ProFessional 4:

Yes

56. Program ProSelf:

Yes

53. Program ProFessional 6:

Yes

57. Program ProEco:

Yes

54. Program ProFessional 8:

Yes

58. Program ProLong:

Yes