

Technical data sheet



Product features

Fry-top griddle plate 65x48 electric smooth counter top 400 V

Model	SAP Code	00000985
--------------	-----------------	----------



- Top type: Smooth
- Griddle dimensions [mm x mm]: 650 x 480
- Griddle thickness [mm]: 10.00
- Container for liquid fat: Yes
- Maximum device temperature [°C]: 300
- Removable rim: No

SAP Code	00000985	Power electric [kW]	6.000
Net Width [mm]	658	Loading	400 V / 3N - 50 Hz
Net Depth [mm]	541	Griddle dimensions [mm x mm]	650 x 480
Net Height [mm]	285	Top type	Smooth
Net Weight [kg]	44.00		

Technical data sheet



Technical drawing

Fry-top griddle plate 65x48 electric smooth counter top 400 V

Model	SAP Code	00000985
-------	----------	----------

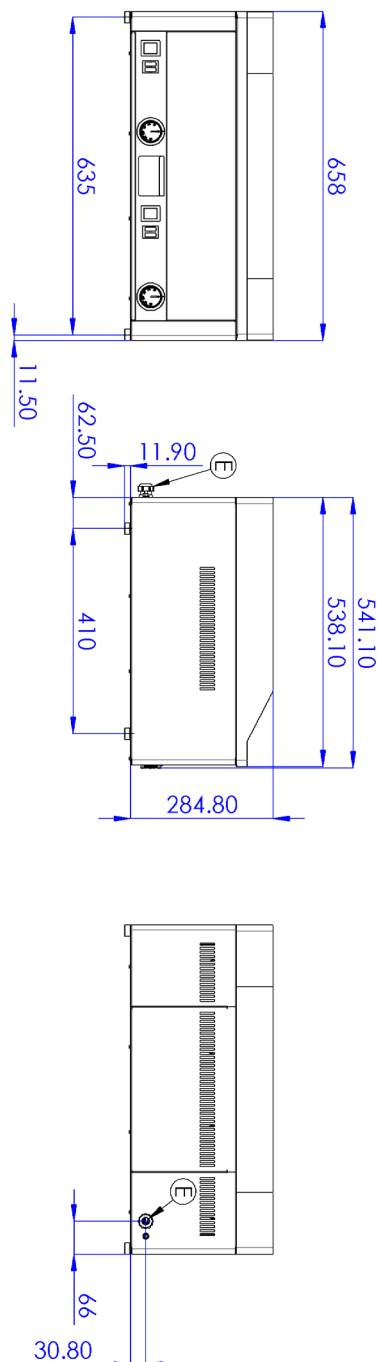

Fry-top griddle plate 65x48 electric smooth counter top 400 V

Model

SAP Code

00000985

1

All-stainless design

long life
resistance of AISI 304 stainless steel material
the material does not cut

- savings on service interventions
- easy cleaning and maintenance of equipment

2

Degree of protection of the control elements IPX4

maintenance-free system
resistance to splash water
long life

- savings on service interventions
- easy cleaning and maintenance of equipment

3

Outlet for waste liquids

ensures that oil drips into the socket

- easy maintenance
- easy cleaning

4

High non-removable hem

better hygienic conditions
preventing grease from splashing onto ancillary equipment

- easy maintenance
- easy cleaning

5

Sandblasted steel plate

good heat transfer
uniform heating

- time-saving for food preparation
- no reheating and long cooking times

6

Cooking unit for use on a table or on a base

variable use
the possibility of placement in smaller spaces

- easy handling
- cost savings on substructure

Technical data sheet



Technical parameters

Fry-top griddle plate 65x48 electric smooth counter top 400 V

Model	SAP Code	00000985
--------------	-----------------	----------

1. SAP Code:

00000985

2. Article group:

Frying plates

3. Net Width [mm]:

658

4. Net Depth [mm]:

541

5. Net Height [mm]:

285

6. Net Weight [kg]:

44.00

7. Gross Width [mm]:

640

8. Gross depth [mm]:

725

9. Gross Height [mm]:

410

10. Gross Weight [kg]:

49.00

11. Device type:

Electric unit

12. Construction type of device:

Table top

13. Power electric [kW]:

6.000

14. Loading:

400 V / 3N - 50 Hz

15. Protection of controls:

IPX4

16. Material:

AISI 430

17. Indicators:

operation and warm-up

18. Maximum device temperature [°C]:

300

19. Minimum device temperature [°C]:

50

20. Adjustable feet:

Yes

21. Griddle dimensions [mm x mm]:

650 x 480

22. Griddle thickness [mm]:

10.00

23. Container for liquid fat:

Yes

24. Removable rim:

No

25. Uniform heating:

Yes

26. Top type:

Smooth