

# Technical data sheet



## Product features

### Pasta cooker 7 l with drain tap

<b>Model</b>	<b>SAP Code</b>	00015019
--------------	-----------------	----------



- Basin volume [l]: 8
- Material: AISI 430
- Protection of controls: IPX4
- Maximum device temperature [°C]: 110

<b>SAP Code</b>	00015019	<b>Net Weight [kg]</b>	9.00
<b>Net Width [mm]</b>	270	<b>Power electric [kW]</b>	3.400
<b>Net Depth [mm]</b>	420	<b>Loading</b>	230 V / 1N - 50 Hz
<b>Net Height [mm]</b>	370	<b>Basin volume [l]</b>	8

# Technical data sheet



Technical drawing

Pasta cooker 7 l with drain tap

Model

SAP Code

00015019

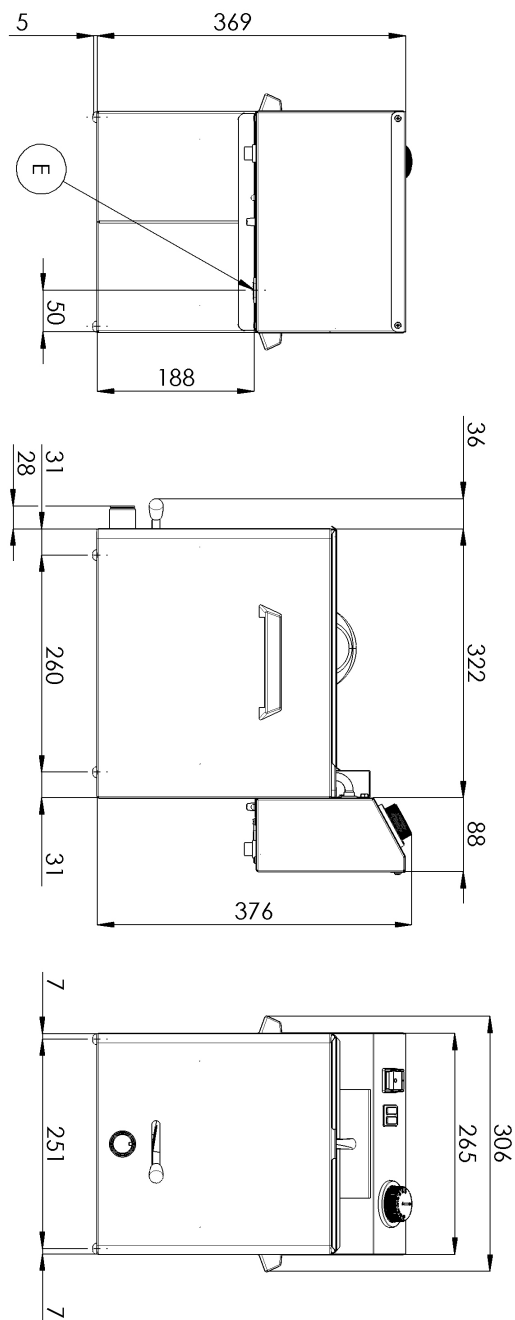

# Technical data sheet



## Technical parameters

### Pasta cooker 7 l with drain tap

Model

SAP Code

00015019

**1. SAP Code:**

00015019

**2. Article group:**

Pasta cookers

**3. Net Width [mm]:**

270

**4. Net Depth [mm]:**

420

**5. Net Height [mm]:**

370

**6. Net Weight [kg]:**

9.00

**7. Gross Width [mm]:**

310

**8. Gross depth [mm]:**

515

**9. Gross Height [mm]:**

440

**10. Gross Weight [kg]:**

10.00

**11. Device type:**

Electric unit

**12. Construction type of device:**

Table top

**13. Power electric [kW]:**

3.400

**14. Loading:**

230 V / 1N - 50 Hz

**15. Protection of controls:**

IPX4

**16. Device color:**

Stainless steel

**17. Material:**

AISI 430

**18. Indicators:**

operation and warm-up

**19. Basin volume [l]:**

8

**20. Maximum device temperature [°C]:**

110

**21. Minimum device temperature [°C]:**

30