

Technical data sheet



Product features

Cooking range solid top gas with static gas oven GN 2/1 - 5x burner

Model	SAP Code	00020538
--------------	-----------------	----------



- Device type: Gas unit
- Ignition: Piezo
- Protection of controls: IPX4

SAP Code	00020538	Power gas [kW]	42.400
Net Width [mm]	1200	Type of gas	Natural gas, propane butane
Net Depth [mm]	700	Width of internal part [mm]	657
Net Height [mm]	900	Depth of internal part [mm]	558
Net Weight [kg]	175.00	Height of internal part [mm]	308

Technical data sheet



Technical drawing

Cooking range solid top gas with static gas oven GN 2/1 - 5x burner

Model	SAP Code	00020538
-------	----------	----------

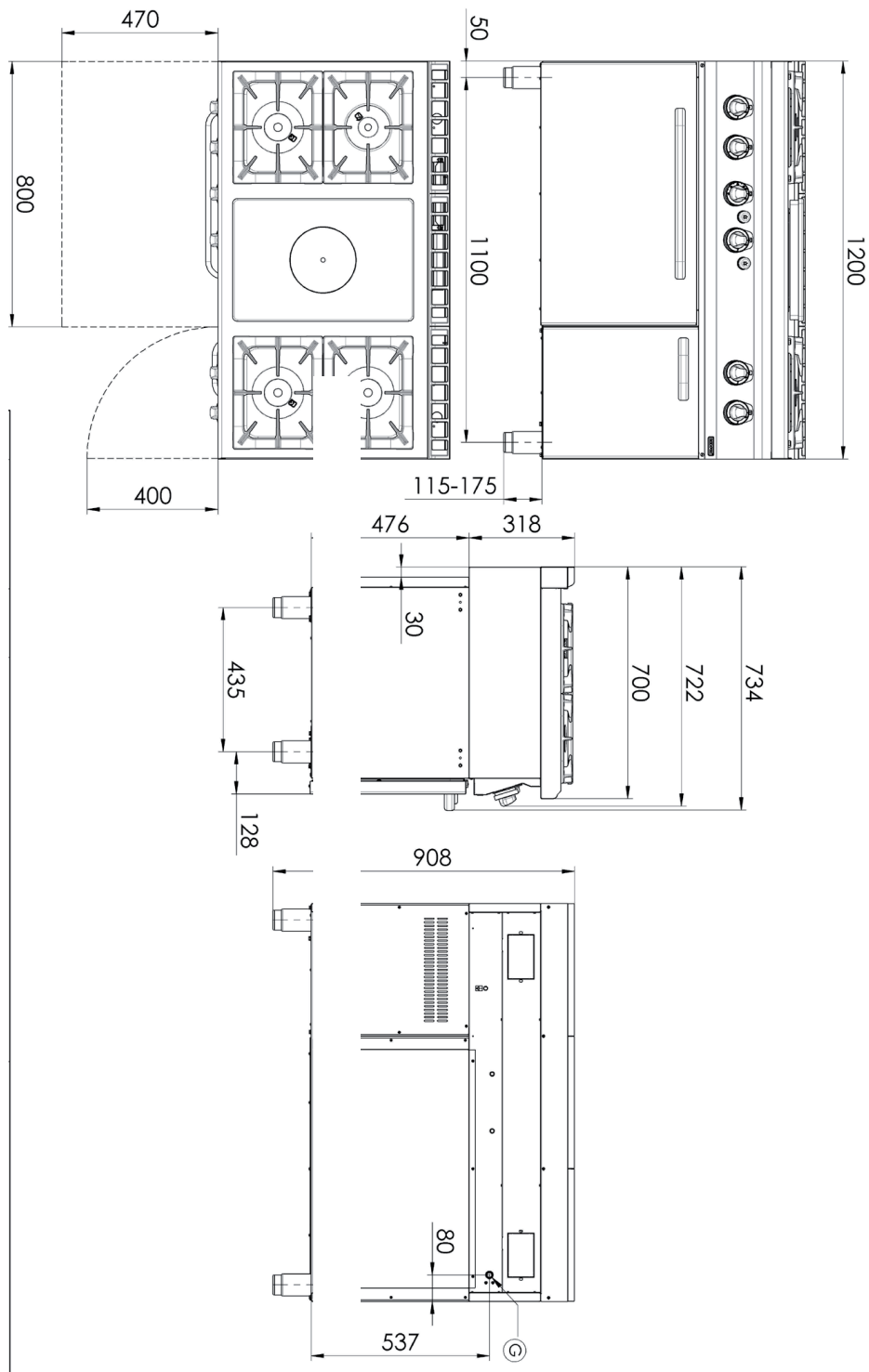

Technical data sheet



Technical parameters

Cooking range solid top gas with static gas oven GN 2/1 - 5x burner

Model

SAP Code

00020538

1. SAP Code:

00020538

2. Article group:

Stoves with oven

3. Net Width [mm]:

1200

4. Net Depth [mm]:

700

5. Net Height [mm]:

900

6. Net Weight [kg]:

175.00

7. Gross Width [mm]:

1240

8. Gross depth [mm]:

800

9. Gross Height [mm]:

975

10. Gross Weight [kg]:

175.00

11. Device type:

Gas unit

12. Construction type of device:

With substructure

13. Power gas [kW]:

42.400

14. Ignition:

Piezo

15. Type of gas:

Natural gas, propane butane

16. Protection of controls:

IPX4

17. Indicators:

operation and warm-up

18. Worktop material:

AISI 304

19. Worktop Thickness [mm]:

1.20

20. Number of power control stages:

6

21. Safety thermocouple:

Yes

22. Number of burners/hot plates:

5

23. Type of gas cooking zones:

Fire protection to install + Classic burners

24. Burner type:

Brass, detachable

25. Oven Type:

gas static

26. Oven size:

GN 2/1

27. Oven material:

Stainless steel

28. Width of internal part [mm]:

657

Technical data sheet



Technical parameters

Cooking range solid top gas with static gas oven GN 2/1 - 5x burner

Model

SAP Code

00020538

29. Depth of internal part [mm]:

558

31. Maximum temperature of the inner chamber [°C]:

300

30. Height of internal part [mm]:

308

32. Minimum temperature of the inner chamber [°C]:

50